

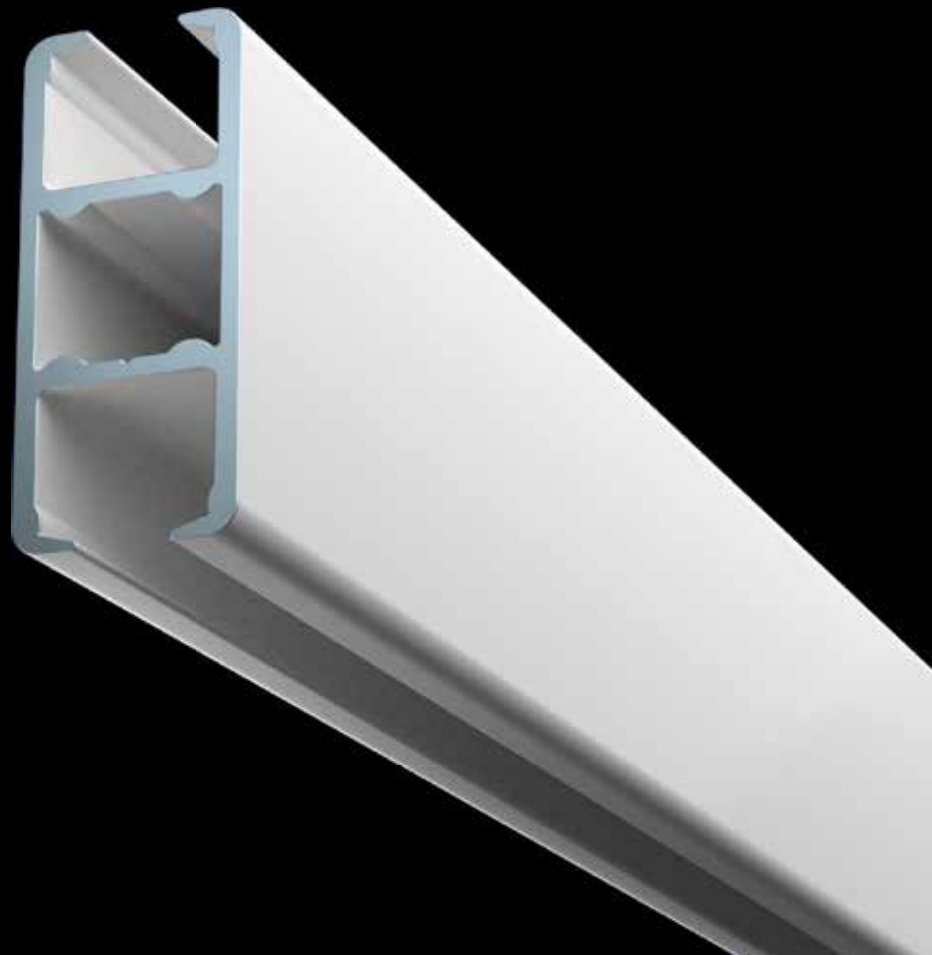

GOELST
curtain rail systems

Cubicle curtain rail

your rail in our care





The standard in healthcare

For many years now, Goelst cubicle curtain rails have set the standard in healthcare applications. The quality and functionality of the rails, as well as the many accessories and years of experience have earned Goelst its prominent position in this sector.

These rail types are also used extensively to divide spaces in changing rooms, beauty therapy classrooms etc. By using suspension hangers, the rails can be supported below the ceiling.

Cubicle curtain rail

Cubicle rail is available in two types: type 4100 is a slim, rectangular rail, type 5100 has a round shape. The rails are available with practical accessories, such as IV racks, IV hooks and curtain holders.

Both rail types can be installed on either wall or ceiling, but can also be suspended from the ceiling with suspension hangers. The rails are available in our standard colours or can be RAL coloured by special request. They can be equipped with a dust-cover strip to facilitate cleaning. Our systems can be installed fully insulated against static electricity. Furthermore, it is possible to equip the rails with LRS, an option developed for institutions with a heightened risk of strangulation.

Load Release System (LRS)

Goelst cubicle- and shower rails can be equipped with a Load Release System (LRS). This unique, patented system will release the rail from its activation points when it is subjected to a sudden peak load of 35 kg (subject to installation). The rail can subsequently be reinstalled without the need of specialist tools.

The Load Release System is our answer to a requirement of the healthcare sector. The need for collapsible, risk reducing rails became apparent, specifically in environments with a heightened ligature risk.

The components of the system have been designed for rail types 4100 and 5100. The LRS device is unobtrusive when the rail is in normal use.

Curtain rails are our expertise

Goelst is a Dutch manufacturer of aluminium curtain rail systems. With over thirty years of experience, we offer a comprehensive range of high-quality, versatile curtain rail systems, suitable for all curtain types.

Only the finest synthetics are used by our in-house injection moulding department for the manufacture of components. Goelst systems are known for their unparalleled gliding properties. Bespoke products are our forte. As well as general customisation, we offer unique, customer-specific solutions.

Our own R&D department and production facilities allow us to provide ongoing development and innovation. In short, Goelst provides the experience, facilities and ability to complete any rail-related challenge.

Types

- **4100:** a strong, slim cubicle rail, available with practical accessories.
- **5100:** a robust, round cubicle rail, also available with practical accessories. Cross-connections, as in application of IV rail above beds, can be perfectly finished using hollow end caps (ref: 5153-20).

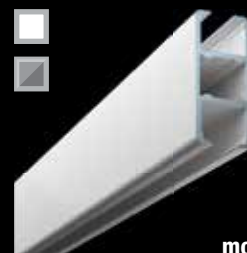

model 4100

the strong standard for privacy curtain tracks
394 gr/m | 34 x 15 mm



model 5100

the stable decorative privacy curtain track
522 gr/m | 26 x 28 mm



GOELST
curtain rail systems

Specification guide

Material

- Aluminium EN AW-6060-T66.
- Anodised in accordance with the Qualanod standard.
- Powder coated in accordance with the Qualicoat standard.

Accessories

Glider-hooks 4007-60 (rotating glider with SS hook) at 10 per metre, two end stops 4001-M-60 per length. Dust cover 4145 and connecting bridge 4165 to suit.

Installation

Ceiling fixing with 4135 ceiling fixing plate, 4254 mini suspension hanger, 4155 suspension hanger, 4160 or 4161 V hanger, 4064 strut hanger with plate.

Wall fixing with 4149 wall support, 4141 wall bracket or 4140 plexiglass wall bracket.

NEN-1010: Official standard for anti static rail installation.

Ceiling fixing with suspension hanger 4155 (using synthetic ceiling stud 4156), wall fixing with plexiglass wall bracket 4140 and synthetic wall support 4149.

Bending

Minimum radius 25 cm. Larger radius advised for improved operation.

Standard colours



9010



natural silver
anodised

other RAL colours & specail coatings on request

Product example

Example of a 2-bed room with 5100-system installed. Showing the use of strut hanger 4064 at the point where no wall fixing can be achieved, in this case due to the presence of a window.

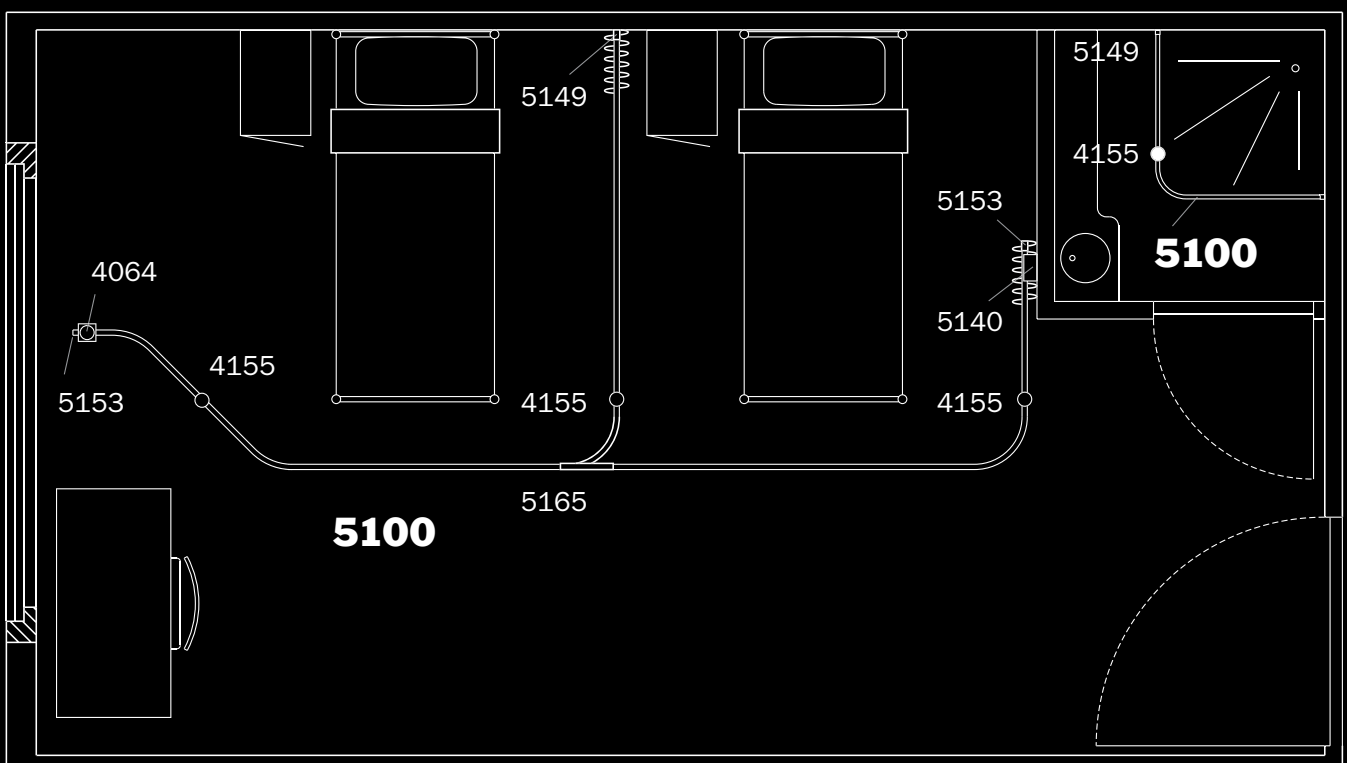

Components

Curtain transport



4002
end stop
without eye



4003
spring stop



4007
rotating glider



4007-60
rotating glider
with curtain hook



4020
heavy duty glider
for the 4180

Ceiling mounting

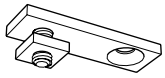

4135 (for 4100)
5135 (for 5100)
ceiling bracket



4254
suspension hanger
3 cm.



4155
suspension hanger

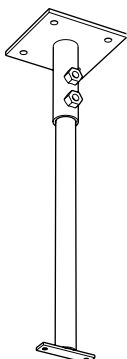

4064
strut hanger

Wall mounting

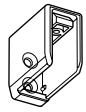

4149
wall bracket
(4100)

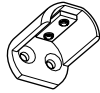

5149
wall bracket
(5100)

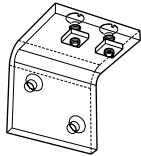

4140 (for 4100)
5140 (for 5100)
wall bracket
transparent for anti
static installation
5 cm

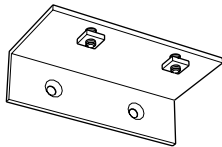

4141 (for 4100)
5141 (for 5100)
wall bracket 5 cm

Accessories

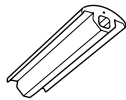

4145
dust cover

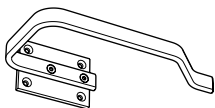

4170
curtain holdback
with fixing plate

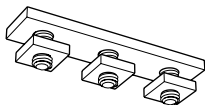

4130 (for 4100)
5130 (for 5100)
connection bracket

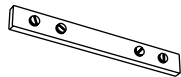

5152
connection bridge
(5100)

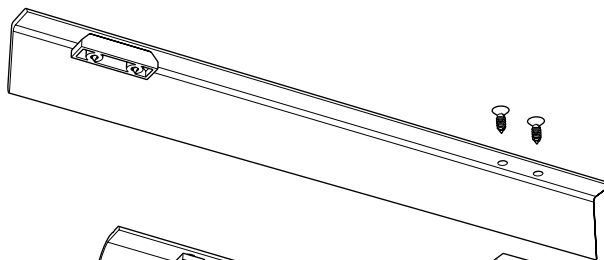

4165
connection bridge
(4100)

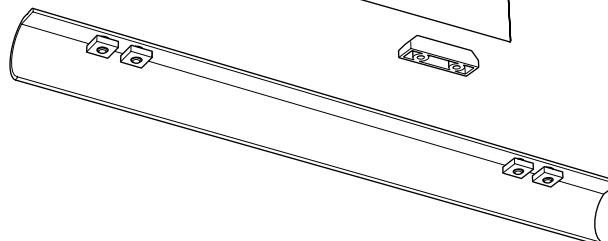

5165
connection bridge
(5100)



5153-20
end cap hollow
in combination
with 5130
(5100)

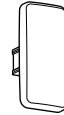

4153
end cap
(4100)



5153
end cap
(5100)

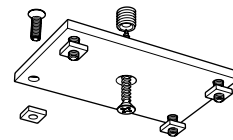

4116 (for 4100)
5116 (for 5100)
bridging plate



4181-30
infusion bottle
hook 30 cm



4181-50
infusion bottle
hook 50 cm

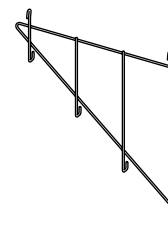

4180
infusion bottle
rack

Safe, trusted and complete: cubicle curtain rail by Goelst.



Goelst NL B.V.

P.O. Box 480 | 6710 BL Ede | The Netherlands | T +31 (0)318 648 100
F +31 (0)318 648 109 | info@goelst.com | www.goelst.com