



GOELST
curtain rail systems

Roman blind systems

comfort and class



Versatile with style

Goelst roman blind systems are remarkably versatile. They are used as stand-alone window treatments or in combination with other curtain types. The character of a roman blind brings warmth to any interior and will easily regulate the incidence of light, acoustics and privacy.

Since fabrics can be draped in various ways, roman blinds can be applied to many interior styles. Moreover, a roman blind can be the ideal solution in restricted spaces where regular curtains cannot be hung, or where it is preferable to regulate light without having to block the view with curtains.

Goelst roman blind systems

Goelst offers several roman blind systems. Choose the system that best suits your fabric weight, dimensions, desired look and shape of the window. Systems can be both wall- and ceiling mounted.

The blinds can be operated by chain or electrically. In each case, blinds can be stopped at any desired height. The curtain fabric is attached to the system using Velcro tape, facilitating easy removal for cleaning.

Goelst system 7400 can be upholstered with fabric to hide the tape guides and the motor from view. Simultaneously, the fabric will muffle the motor sound. A template is available for this fabric design.

Curtain rails are our expertise

Goelst is a Dutch manufacturer of aluminium curtain rail systems. With over thirty years of experience, we offer a comprehensive range of high-quality, versatile curtain rail systems, suitable for all curtain types.

Only the finest synthetics are used by our in-house injection moulding department for the manufacture of components. Goelst systems are known for their unparalleled gliding properties.

Bespoke products are our forte. As well as general customisation, we offer unique, customer-specific solutions. Our own R&D department and production facilities allow us to provide ongoing development and innovation. In short, Goelst provides the experience, facilities and ability to complete any rail-related challenge.



Types

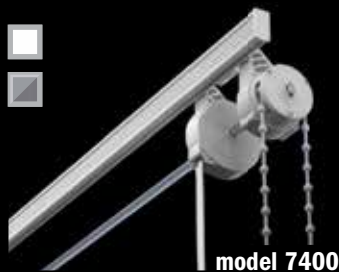

model 7400

7400 ball chain operated
190 gr/m | 23 x 10 mm



model 7400-E

7400 electrically operated
190 gr/m | 23 x 10 mm

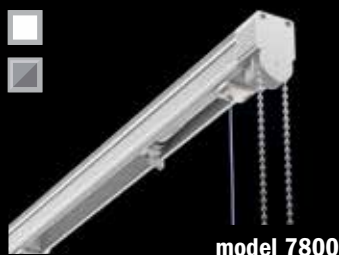

model 7800

7800 ball chain operated
378 gr/m | 14 x 37 mm

- **7400:** system 7400 uses tape guides with ribbon and can operate from the perpendicular to a maximum angle of 15 degrees. Chain operated. Available in white or natural aluminium. For fabric weights up to 6 kg.
- **7400-E:** electrically operated version of the 7400 roman blind system, available with either 230 V or 110 V motors. Equipped with an automatic top and bottom limit switch. Motorized by standard or heavy-duty motor (for curtain loads of 9 and 19 kg respectively).
- **7800:** type 7800 is a system with cassette, equipped with 1:1 or 2:1 operation. Optional semi-automatic function. Finished in white. For fabric weights up to 7 kg (3 kg with semi-automatic option).



GOELST
curtain rail systems

Specification guide

Material

- Aluminium EN AW-6060-T66.
- Powder coated in accordance with the Qualicoat standard.

Accessories (standard)

7400

Chain control 7430 (1:1) or 7431 (1:5), endless chain white 7432, end cap 7453, tape guide 7440 with tape and transparent clip for tape 7426 and aluminium hexagonal drive shaft 7411-N.

Accessories (semi-automatic option)

Chain control 1:1 7830-H-L (left) and 7830-H-R (right) or 2:1 7831-H-L (left) and 7831-H-R (right), ball chain (various colours) 7832, end cap 7853, wind up cone with 300 cm cord (various colours) 7840-300, hook for cord 7826, aluminium hexagonal drive shaft 7411-N, bottom weight 7890-2005-24, bottom rail plastic 7890-2509-W, speed brake 7860.

Installation

Ceiling or wall mounted with 7851-C ceiling/wall bracket. Ceiling or wall mounted with 7850-51-W ceiling/wall bracket.

Standard colours



9010



9016

System features

	7800		7800 semi automatic	
	min.	max.	min.	max.
System width	50 cm	500 cm	50 cm	300 cm
System height	-	300 cm	-	300 cm
Load	-	7 kg	0.4 kg	3 kg
Number of winding spindles	2	10	2	10
Load per winding spindle	-	0.7 kg	min. 0.2 kg in bottom bar	0.7 kg



Components

Profile

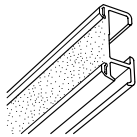

7400
profile
(7400)

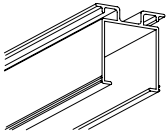

7800
U-profile with velcro
(7800)

Wall/Ceiling mounting

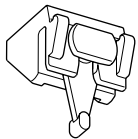

7450
ceiling bracket
(7400)

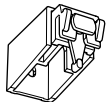

7451
wall bracket 6 cm
(7400)

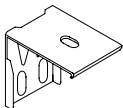

7850-51
ceiling/wall bracket
(7800)

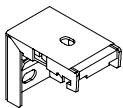

7851-C
ceiling/wall bracket
(7800)

Controls

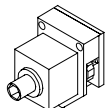

7830
control 1:1 without chain
(7800)

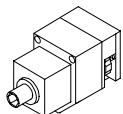

7831
control 2:1 without chain
(7800)

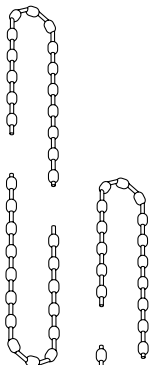

7432
endless chain
100 cm
120 cm
125 cm
150 cm
170 cm
175 cm
200 cm
(7400)

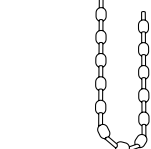

7832
endless chain
100 cm
120 cm
125 cm
150 cm
170 cm
175 cm
200 cm
(7800)



7440-400
tape guide with tape
(7400)

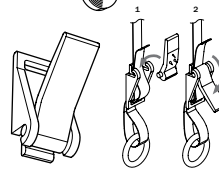

7426
transparent clip
for tape
(7400)

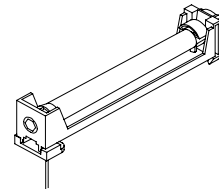

7840-300
cord drum with cord
(7800)

Accessories

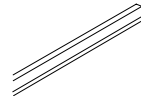

7411-N-6
hexagonal drive
shaft aluminium
(7800)

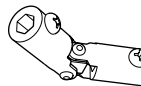

7425
U-joint
(7400)

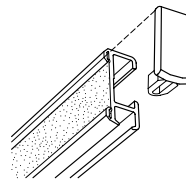

7453
end cap
(7400)

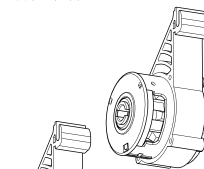

7430L & 7430R
chain guide left & right 1:1
(7400)

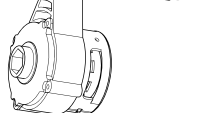

7431L & 7431R
chain guide left & right 1:5
(7400)



7826
hook for cord
(7800)



7490-203R
counter weight
(7400)



7490-206R
counter weight
(7400)



7890
counter weight metal
for semi-automatic
(7800)

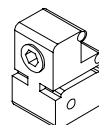

7860
speed reducer for
semi-automatic
(7800)



7853
end cap
(7800)

Discover the versatility and thought-through finish of Goelst roman blind systems.



Goelst NL B.V.

P.O. Box 480 | 6710 BL Ede | The Netherlands | T +31 (0)318 648 100
F +31 (0)318 648 109 | info@goelst.com | www.goelst.com